

INSPECTION

1. INSPECT WATER PUMP

- (a) Visually check the air hole and water hole for coolant leakage.

If leakage is found, replace the water pump and timing belt.

- (b) Turn the pulley, and check that the water pump bearing moves smoothly and quietly.

If necessary, replace the water pump.

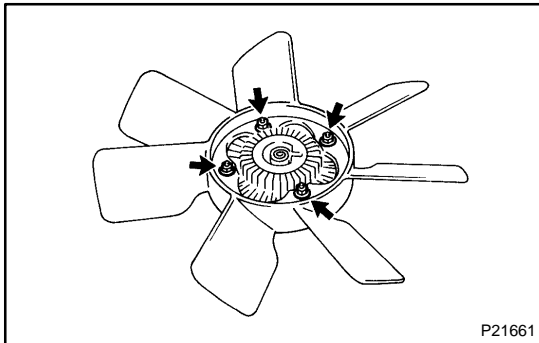

2. INSPECT FLUID COUPLING

- (a) Remove the 4 nuts and fan from the fluid coupling.

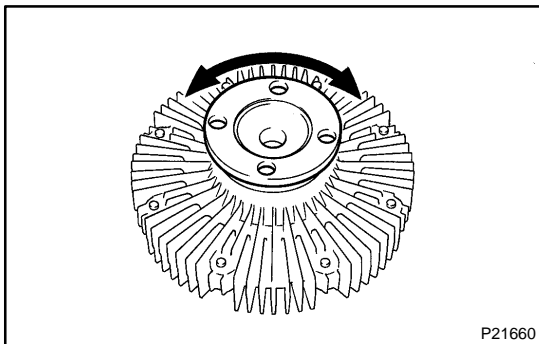

- (b) Check that the fluid coupling is not damaged and that no silicon oil leaks.

If necessary, replace the fluid coupling.

- (c) Reinstall the fan to the fluid coupling with the 4 nuts.

Torque: 5.4 N·m (55 kgf·cm, 47 in.-lbf)

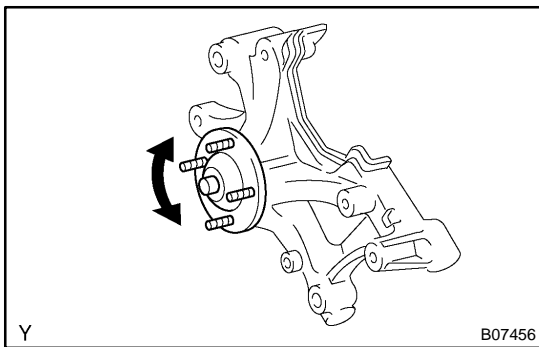

3. INSPECT FAN PULLEY BRACKET

Check the turning smoothness of the fan pulley.

If necessary, replace the pulley bracket.

4. INSPECT TIMING BELT COMPONENTS

(See page [EM-21](#))